



### **Non-Rising Stem Resilient-Seated(NRS) Ductile Iron Gate Valve(Grooved End)**

You are welcomed to come to our factory to buy the latest selling, low price, and high-quality Hispeed® Non-Rising Stem Resilient-Seated(NRS) Ductile Iron Gate Valve(Grooved End). We supply Non-Rising Stem Resilient-Seated(NRS) Ductile Iron Gate Valve(Grooved End).The Non-Rising Stem Resilient-Seated(NRS) Ductile Iron Gate Valve provides full flow with minimal pressure drop. The

Gate Valve features a groove, easy installation and accessibility. The HISPEED® grooved ductile iron gate valve may be used in commercial and industrial applications, including water supply, waste water, gas supply, fire protection, HVAC and irrigation.Choose HISPEED® gate valves for the most specified, versatile and economical valve option in commercial, mechanical and industrial applications.We are expecting to become your long term partner in China.

#### **Product Description**

You can rest assured to buy customized Hispeed® Non-Rising Stem Resilient-Seated(NRS) Ductile Iron Gate Valve(Grooved End) from us. We will always adhere to the principle of "quality first, client first," and we cordially invite customers to visit us for consultation.

The Non-Rising Stem Resilient-Seated(NRS) Ductile Iron Gate Valve provides full flow with minimal pressure drop. The Gate Valve features a groove, easy installation and accessibility.The HISPEED® flanged ductile iron gate valve may be used in commercial and industrial applications, including water supply, waste water, gas supply, fire protection, HVAC and irrigation.Choose HISPEED® gate valves for the most specified, versatile and economical valve option in commercial, mechanical and industrial applications.We are expecting to become your long term partner in China.We normally continually supply you with essentially the most conscientious shopper support, along with the widest variety of designs and styles with finest materials. These attempts include the availability of customized designs with speed and dispatch for Wholesale Price China China Flanged Resilient Seated Gate Valve Short Pattern, With us your money in protected your organization in safe . Hope we are able to be your trustworthy supplier in China . Looking ahead for your cooperation . Wholesale Price China China Gate Valve,Ductile Iron Resilient Seat, With well educated, innovative and energetic staff, we are responsible for all elements of research, design, manufacture, sale and distribution. By studying and developing new techniques, we are not only following but also leading fashion industry. We listen attentively to the feedback from our customers and provide instant replies. You will instantly feel our professional and attentive service.

**Product Parameter (Specification)**

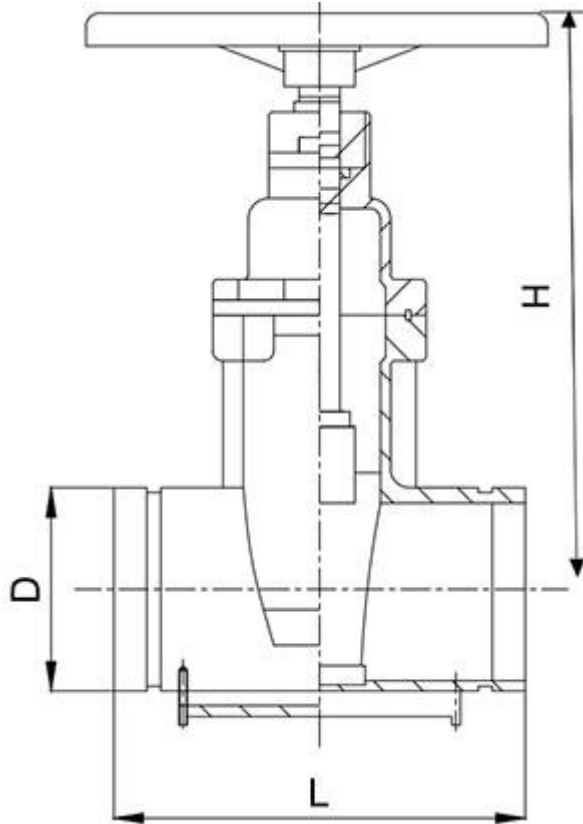

Size	2"		2.5"		3"		4"		5"		6"		8"		10"		12"	
	mm	inch	mm	inch	mm	inch	mm	inch	mm	inch	mm	inch	mm	inch	mm	inch	mm	inch
OD	60.3	2-3/8	73.0	2-7/8	88.9	3 1/2	114.3	4 1/2	139.7	5-1/2	165.1	6-1/2	219.1	8-5/8	273.0	10-3/4	323.9	12-3/4
L	178	7	190.5	7-1/2	203	8	229	9	254	10	267	10-1/2	292	11-1/2	330	13	356	14
H	261.5	8-1/2	270	10-5/8	296	11-5/8	350	13-3/4	410	16-1/8	455	17-15/16	545	21-7/16	645	25-3/8	730	28-3/4

**Product Feature And Application**

Meet or exceed AWWA C515/BS/EN/DIN

Full Waterway

Adjustable Packing

Ductile Iron Wedge, EPDM Encapsulated

Face to Face Dimensions to ANSI/ASME B16.10, EN558 S03

Groove ends to AWWA C606

300PSI/PN16

Fusion Bonded Epoxy Coated Interior and Exterior to AWWA C550 Standard

**Product Details**

Available with Supervisory Switch

ASTM B150 Bronze Stem Available

ASTM A276 Type 316/431/420 Stainless Steel Available

<b>Part</b>	<b>Material</b>	<b>ASTM Specification</b>
<b>Body</b>	Ductile Iron	A536 Grade 65-45-12
<b>Wedge</b>	EPDM Fully Encapsulated Ductile Iron	
<b>Wedge Nut</b>	Stainless Steel	A351 Grade CF8
<b>Bonnet</b>	Ductile Iron	A536 Grade 65-45-12
<b>Yoke</b>	Ductile Iron	A536 Grade 65-45-12
<b>Stem</b>	Stainless Steel	A276 Type 304
<b>Stem Nut</b>	Bronze	B148 C95200
<b>Body/Bonnet Gasket</b>	Rubber	D2000 EPDM
<b>Packing</b>	Graphite	Non-Asbestos
<b>Gland</b>	Ductile Iron	A536 Grade 65-45-12
<b>Gland stud</b>	Stainless Steel	F593 Grade 304
<b>Bonnet Fasteners</b>	Carbon Steel	A307 Grade B
<b>Plug</b>	Malleable Iron	A47 Grade 22010
<b>Handwheel</b>	Ductile Iron	A536 Grade 65-45-12

**Deliver, Shipping And Serving**

Ship from Qingdao or another Seaports

**FAQ**

	<b>Q</b>	<b>A</b>
1	How many days you need to install the equipment?	Unwanted.
2	How many staff abroad you sent to install the equipment?	Unwanted.
3	Can I transfer the money to you then you pay to other supplier?	YES.
4	Can I delivery the goods from other supplier to your factory? Then load together?	YES.
5	When will you leave your factory and to have your spring festival holidays?	According to national regulations.
6	Can the equipment be installed under hot weather?	YES.

7	Can Your products be installed under the cold weather?	YES.
8	Do You have office in shanghai or guangzhou that i can visit?	NONE.
9	Can you send your staff to install the equipment for us?	Unwanted.
10	Can I only buy some spare parts from you?	YES.
11	Will you will attend the fair to show your products?	YES.
12	Can you send your equipment to my warehouse in guangzhou?	YES.
13	How long it takes you to provide the designing options for us?	3 days at most.
14	What is your products standardization?	AWWA BS AIP WRAS FM.
15	How do you pack the equipment?	Negotiate with the customer.
16	Can you can design the equipment according to our size?	YES.
17	How many years have your company made this kind of equipment?	5 years.
18	Which certificate do you have for your equipment?	FM.
19	How many staffs do you have in your factory?	200
20	Do you have any agent in our country?	NONE.
21	Do you have any real project pictures of the equipment?	YES.
22	How far is your factory from the city hotel?	10 km.
23	How far is your factory from the airport?	10 km.

24	How long it will take from guangzhou to your factory?	5 hours.
25	Where is your factory located?	Weifang City, Shandong province.
26	Do you provide free spare parts?	It depends.
27	What is the age range for your products?	Everyone.
28	Do you have detailed and professional installation manual?	YES.
29	If OEM is acceptable?	YES.
30	Do you provide sample? Free or charge?	It depends.
31	What is your term of payment?	30% payment in advance, 70% paid before shipment.
32	What is your MOQ?	One container.
33	Are you a trading company or a manufacturer?	Trade and Industry combination group company.
34	How long is your delivery time?	25-40 days.