



300PSI Ductile Iron Double Eccentric Butterfly Valve

The following is the introduction of high quality Hispeed® 300PSI Ductile Iron Double Eccentric Butterfly Valve, We supply 300PSI Ductile Iron Double Eccentric Butterfly Valve. The HISPEED® Ductile Iron Double Eccentric Butterfly Valves are used, for example, as system, sectional and pump water control valves. The HISPEED® Ductile Iron Double Eccentric Butterfly Valve may be used in commercial and industrial applications, including water supply, waste water, gas supply, fire protection, HVAC and irrigation. Choose HISPEED® Ductile Iron Double Eccentric Butterfly Valve for the most specified, versatile and economical valve option in commercial, mechanical and industrial applications. The butterfly valve features a Class 125 flange, easy installation and accessibility. We are expecting to become your long term partner in China.

Product Description

As the professional manufacture, we would like to provide you Hispeed® 300PSI Ductile Iron Double Eccentric Butterfly Valve. Products and services are the life of an enterprise. We have always attached great importance to product quality and after-sales tracking services. We strive to provide customers with satisfactory products and services through our own efforts.

The HISPEED® Ductile Iron Double Eccentric Butterfly Valves are used, for example, as system, sectional and pump water control valves. The HISPEED® Ductile Iron Double Eccentric Butterfly Valve may be used in commercial and industrial applications, including water supply, waste water, gas supply, fire protection, HVAC and irrigation. Choose HISPEED® Ductile Iron Double Eccentric Butterfly Valve for the most specified, versatile and economical valve option in commercial, mechanical and industrial applications. The butterfly valve features a Class 125 flange, easy installation and accessibility. We are expecting to become your long term partner in China. With reliable high-quality process, superior reputation and excellent customer assistance, the series of items produced by our company are exported to a lot of countries and regions for Fixed Competitive Price China API Ductile Iron Double Flanged Double Eccentric Butterfly Valves with Worm Gear Butterfly Valve, Presently, we are looking forward to even larger cooperation with overseas clients based on mutual benefits. Make sure you come to feel no cost to make contact with us for more information. Fixed Competitive Price China Manual Butterfly Valve, Flanged Butterfly Valve, The company attaches great importance to product quality and service quality, based on the business philosophy "good with people, genuine to

whole world, your satisfaction is our pursuit". we design merchandise, According to customer's sample and requirements, to meet the needs of the market and provide different customers with individualized service. Our company warmly welcomes friends at home and abroad to visit, to discuss cooperation and seek common development.

Product Parameter (Specification)

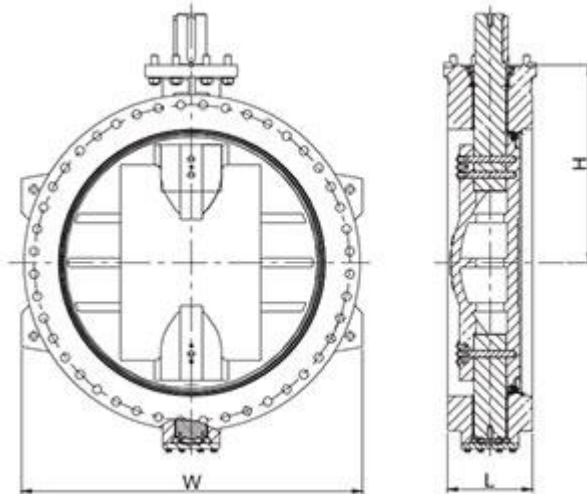

Size	30"	36"	42"	48"	54"	60"	66"	72"	78"	90"	96"
L		12 (305)			15 (381)			18 (457)		24 (610)	24 (610)
H	24.5 (625)	28.5 (725)	32.5 (825)	35 (890)	39 (990)	43 (1095)	49 (1045)	52.5 (1330)	52.5 (1330)	59 (1550)	62.5 (1590)
W	40 (1020)	48 (1220)	55 (1400)	61 (1550)	67 (1700)	74 (1880)	81 (2060)	88 (2235)	94 (2390)	108 (2745)	115 (2920)

Product Feature And Application

Meet or exceed AWWA C504/C516

Double eccentric type

Robust design

Stainless steel seat welded on the body

Mounting flange in accordance with MSS-SP-102 or ISO 5211

Flange and drilling complies with ASME B16.1 Class125

300PSI

Fusion Bonded Epoxy Coated Interior and Exterior to AWWA C550 Standard

Product Details

Part	Material	ASTM Specification
Body	Ductile Iron	A536 65-45-12
Body Seat	Stainless Steel	A276 Grade 304
Shaft	Stainless Steel	A276 Grade 304
Disc	Ductile Iron	A536 65-45-12
Disc Seat Ring	Rubber	D2000 EPDM
Disc Holding Plate	Stainless Steel	A276 Grade 304
Shaft Bushing	Bronze	B148 C95200
Adjust Spacer	Bronze	B148 C95200
Shaft Sealing	O-Ring	D2000 BUNA-N
Shaft Retainer	Stainless Steel	A276 Grade 304
Bottom Plate	Ductile Iron	A536 65-45-12

Deliver,Shipping And Serving

Ship from Qingdao or another Seaports

FAQ

	Q	A
1	How many days you need to install the equipment?	Unwanted.
2	How many staff abroad you sent to install the equipment?	Unwanted.
3	Can I transfer the money to you then you pay to other supplier?	YES.
4	Can I delivery the goods from other supplier to your factory? Then load together?	YES.
5	When will you leave your factory and to have your spring festival holidays?	According to national regulations.
6	Can the equipment be installed under hot weather?	YES.
7	Can Your products be installed under the cold weather?	YES.
8	Do You have office in shanghai or guangzhou that i can visit?	NONE.
9	Can you send your staff to install	Unwanted.

	the equipment for us?	
10	Can I only buy some spare parts from you?	YES.
11	Will you will attend the fair to show your products?	YES.
12	Can you send your equipment to my warehouse in guangzhou?	YES.
13	How long it takes you to provide the designing options for us?	3 days at most.
14	What is your products standardization?	AWWA BS AIP WRAS FM.
15	How do you pack the equipment?	Negotiate with the customer.
16	Can you can design the equipment according to our size?	YES.
17	How many years have your company made this kind of equipment?	5 years.
18	Which certificate do you have for your equipment?	FM.
19	How many staffs do you have in your factory?	200
20	Do you have any agent in our country?	NONE.
21	Do you have any real project pictures of the equipment?	YES.
22	How far is your factory from the city hotel?	10 km.
23	How far is your factory from the airport?	10 km.
24	How long it will take from guangzhou to your factory?	5 hours.
25	Where is your factory located?	Weifang City,Shandong province.
26	Do you provide free spare parts?	It depends.
27	What is the age range for your	Everyone.

	products?	
28	Do you have detailed and professional installation manual?	YES.
29	If OEM is acceptable?	YES.
30	Do you provide sample? Free or charge?	It depends.
31	What is your term of payment?	30% payment in advance, 70% paid before shipment.
32	What is your MOQ?	One container.
33	Are you a trading company or a manufacturer?	Trade and Industry combination group company.
34	How long is your delivery time?	25-40 days.